

Learning Activity

Container Distance Requirements

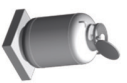

Fill in the blanks on the right to match each container type to its **MINIMUM** distance requirements for relief valve discharges and filling connection when inspecting propane tanks at a residence. **HINT:** Requirements can have more than one answer. *Check your work on page 194.*



a DOT STATIONARY CYLINDER FILLED ON SITE



b UNDERGROUND ASME TANK



c ABOVEGROUND ASME TANK (125-500 GAL W.C.)

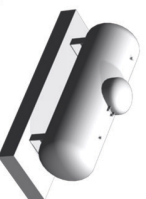

d ABOVEGROUND ASME TANK (501-2000 GAL W.C.)



e ABOVEGROUND ASME TANK (UP TO 2000 GAL W.C.)

LEARNING ACTIVITY



1

- IGNITION SOURCE 10 FT MIN
- VENT / AIR INTAKE 10 FT MIN
- BUILDING OPENING BELOW LEVEL OF DISCHARGE 5 FT MIN
- PROPERTY LINE / IMPORTANT BUILDING 10 FT MIN

2

- IGNITION SOURCE 10 FT MIN
- VENT / AIR INTAKE 10 FT MIN
- BUILDING OPENING BELOW LEVEL OF DISCHARGE 5 FT MIN
- PROPERTY LINE / IMPORTANT BUILDING 25 FT MIN

3

- IGNITION SOURCE 10 FT MIN
- VENT / AIR INTAKE 10 FT MIN
- BUILDING OPENING BELOW LEVEL OF DISCHARGE 3 FT MIN

Lesson 2: Check for Understanding

C. Close, activated. The purpose of a meter creep test is to make sure that the internal valves will close when the emergency discharge control equipment is activated and that there is no detectable leakage through the valve in the closed position.

MODULE 5**Lesson 1: Check for Understanding**

A. True. Openings may be on both the top and bottom of the tank.

Learning Activity: Container Distance Requirements

- 1) B, C
- 2) D, E
- 3) A

Lesson 2: Check for Understanding

B. 10. On underground ASME tanks, the relief valve, filling connection, and fixed maximum liquid level gauge vent connection must be located at least 10 ft from any exterior source of ignition, openings into direct-vent appliances, or mechanical ventilation air intakes.

Lesson 3: Check for Understanding

C. 10. You must park your bobtail at least 10 ft from the customer's storage container when marking deliveries.

MODULE 6**Lesson 1: Check for Understanding**

B. Negative, all the way. When injecting methanol into a negative pressure tank, you must make sure that the hose in the methanol container goes all the way to the bottom.

Lesson 2: Check for Understanding

B. One. You will use one vapor hose if evacuating with a bobtail pump.

Lesson 3: Check for Understanding

A. Reinstall the plug/cap and follow manufacturer's instructions. If an excessive volume of propane leaks out when you remove the plug/cap to the liquid withdrawal connection, you must quickly reinstall the plug/cap and follow manufacturer instructions. Do not continue to remove the plug/cap.